

Dimension: (UNIT:mm)

A	18.0 ± 0.4
B	11.25-0.5
C	8.5 -0.2
D	5.5+0.3
E	12.0 ± 0.4
F	5.85-0.35
G	3.3±0.2
H	

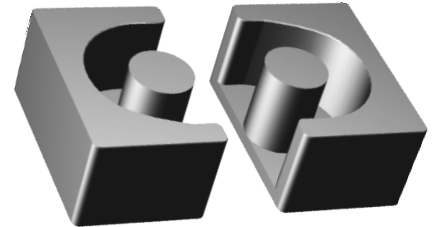
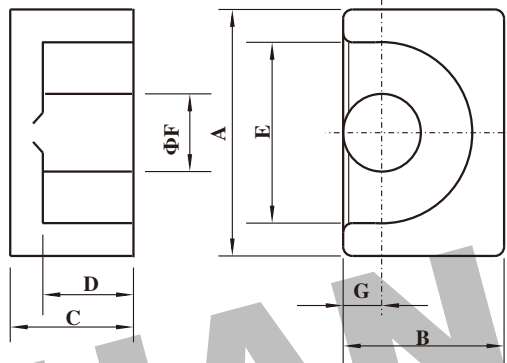

Test conditions

AL: F=1.0KHz U=0.3V N=10Ts

Effective parameter

C1(mm) ⁻¹	Ae(mm ²)	Le(mm)	Ve(mm ³)	Weight(g)
0.87	33.7	29.5	999	≈12

Core sets for filter applications.

Clamping force for AI measurements,40+/-10N.

Core sets of high permeability grades.
Clamping force for AI measurements,40+/-10N

Grade	AL (nH)	μe	Type number
H7K	7100±25%	≈4950	EP 17-H7K
H10K	10400+40/-30%	≈6970	EP 17-H10K

Grade	AL (nH)	μe	AIR GAP μm	Type number
P4	63 ± 3%	≈44	≈1020	EP 17-P4
	100 ± 3%	≈70	≈560	EP 17-P4
	160 ± 3%	≈111	≈310	EP 17-P4
	250 ± 3%	≈174	≈180	EP 17-P4
	315 ± 5%	≈219	≈135	EP 17-P4
	2500 ± 25%	≈1740	≈0	EP 17-P4
HQ2KA	2200 ± 25%	≈1530	≈0	EP 17-HQ2KA
HQ2K	63 ± 3%	≈44	≈1020	EP 17-HQ2K
	100 ± 3%	≈70	≈560	EP 17-HQ2K
	160 ± 3%	≈111	≈310	EP 17-HQ2K
	250 ± 3%	≈174	≈180	EP 17-HQ2K
	315 ± 5%	≈219	≈135	EP 17-HQ2K
	2200 ± 25%	≈1530	≈0	EP 17-HQ2K

Properties of core sets under power conditions

Grade	B (mT)at	Core loss (w) at			
	H=250 A/m F=25KHz T=100°C	F=25 KHz B=200mT T=100°C	f=100 KHz B=100mT T=100°C	F=100 KHz B=200mT T=100°C	F=400 KHz B=50mT T=100°C
P4	≥320	-	≤0.08	≤0.45	-
HQ2KA	≥340	-	≤0.06	≤0.36	≤0.15
HQ2K	≥315	-	≤0.15	-	≤0.2

Properties of core sets under power conditions
(continued)

Grade	B (mT)at	Core loss (w) at			
	H=250 A/m F=25KHz T=100°C	F=500 KHz B=50mT T=100°C	F=500 KHz B=100mT T=100°C	F=1.0 MHz B=30mT T=100°C	F=3.0MHz B=10mT T=100°C
P4	≥320	-	-	-	-
HQ2KA	≥340	≤0.3	-	-	-
HQ2K	≥315	-	-	-	-

Note:

- 1:Document is the property of FUAN Inc & is not allow to be duplicated without authorization
- 2:RoHS compliant.